



Sl	Characteristics	Unit	Parameters
1.1	Cabinet Details		
	Length	mm	2400
	Width	mm	1800
	Height	mm	2400
	Net weight	kg	970
1.2	Internal Dimensions - Chiller		
	Length	mm	960
	Width	mm	1600
	Height	mm	2200
1.3	Internal Dimensions -Freezer		
	Length	mm	1160
	Width	mm	1600
	Height	mm	2200
1.4	Storage space		
	Chiller Room Volume	litre	4600
	Freezer Room Volume	litre	4400
1.5	Cabinet foot print		
	Length x Width	mm	3200 x 1880
	Clear Height	mm	3000
1.6	Door – Panel type with Auto Closure	mm	600 x 1800
2	Shelving		Anodized Aluminium Frames with Polyethylene Shelves
	Chiller	mm	2 Sets x 4 Shelves each
	Freezer	mm	3 Sets x 4 Shelves each
3	Refrigeration system		
	Refrigerant		R404A
	Refrigeration capacity	kW	3
	Room Temp – Chiller / Freezer	Deg C	4 to 8 Deg C / -15 to -20 Deg C
	Type of condensing Unit		Air Cooled Split Type
4	Power Details		



NOTE

Cabinets are available in three laminations
PCGI/SS/PVC/SS finish

Standard kit consists of
3 RMT interconnecting
Piping.



RINAC INDIA LIMITED

Cooling with a warm touch

We, at Rinac, begin with seamless solutions for cold chain and modular construction. Soon, a relationship develops, empowered by our domain expertise, service excellence, and customising capabilities. As the bond deepens, you will discover that we invest in curiosity, innovation, and ingenuity; constantly questioning perfection, and leveraging our resources to nurture each relationship into a win-win proposition. What's more - warm, pro-active support is always just a call away through RinaCare, our dedicated relationship service group.

For more than two decades, Rinac has been the chosen partner for industry leaders, providing an unrivalled range of solutions and superior value. But that's just the tip of the iceberg.

For information and support; Toll Free: +91 18004191166
E-mail: sales@rinac.com | www.rinac.com



RINAC INDIA LIMITED

Cooling with a warm touch

Step into convenience
with a compact cooling system.



Rinac offering ideal cold rooms “Preserva” range of products comprises quick, efficient, adjustable, and compact step in cooling spaces of varying temperature ranges.

PreSera-P is a compact cooling and storage unit with adjustable racks. It stores items of immediate use or those with a short shelf life, such as food items, vegetables, medicines, flowers, milk, and dairy products with a temperature range of +2°C to +8°C.

PreSera-C is a compact step-in-chiller storage unit with adjustable racks. It stores items of immediate use or those with a short shelf life with a temperature range of -2°C to -5°C.

PreSera-N is a compact step in freezer with adjustable racks for freeze storing [Only for holding items such as frozen vegetables, medicines, frozen seafood and meat, as well as milk and dairy products, except ice creams] for prolonged periods, at a temperature range of -12° C to -18° C.

Features

- Quick assembling and dismantling (in three hours)
- Unitary refrigeration system
- Suitable for high ambient condition
- Door handle with key security lock
- Internal lighting
- Four tier adjustable shelving system for maximum utilisation of space
- Microprocessor based programmable electronic control
- Single phase power (230 V) standard 16A power point
- Non CFC refrigerant.

The performance advantages

- Suitable for high ambient condition
- Designed for maximum safety efficiency
- Universal 'Cam Lock Allan Key'
- Insulated cap for cam lock system
- Door handle with key security lock
- Man trap internal safety release lock
- Internal lighting
- Fully functional electronic control
- Energy efficient equipment

Best suited for

- Milk and dairy storage
- Fruit, vegetable and cooked food
- Floriculture
- Food processing
- Pharmaceutical storage
- Hotel s and restaurants
- Food and retail service
- Retail distribution (Cold chain)

Models

Rinac's Sapphire range of modular stepin cold rooms are available in following models

PRESERVA - P Cooler with PCGI/PCGI or SS/SS lamination (Inside/Outside)

PRESERVA - C Chiller with PCGI/PCGI or SS/SS lamination (Inside/Outside)

PRESERVA - N Freezer with PCGI/PCGI or SS/SS lamination (Inside/Outside)

Technical Specifications

Sl	Characteristics	Unit	Preserva P	Preserva C	Preserva N
1	Cabinet Details				
	Length	mm	1800	1800	1800
	Width	mm	1200	1200	1200
	Height	mm	2100	2100	2100
	Net weight	kg	325	340	375
	Insulation thickness	mm	60	60	100
2	Storage space				
	Total Volume	litre	3500	3500	3040
	Shelf Capacity	kg	200	200	150
3	Cabinet foot print				
	Length	mm	1880	1880	1880
	Width	mm	1800	1800	1800
4	Door				
	Panel Door Size	mm	600 x 1650	600 x 1650	600 x 1650
5	Refrigeration system				
	Temperature Range	Deg C	+2 to +8	-2 to -5	-12 to -18
	Refrigerant		R407C	R407C	R404A
	Type of condensing Unit		Air cooled Unitary type	Air cooled Unitary type	Air cooled Unitary type
6	Power Details				
	Consumed Power	kW	1.2	1.6	1.7
	Connected Power	kW	1.7	3.3	3.5
	Power supply		230V, 1 Ph, 50HZ	230V, 1 Ph, 50HZ	230V, 1 Ph, 50HZ



Unitary Refrigeration System



Step-In Friendly



Micro Processor based digital temp indicator (Programable)



Latch With Lock and Lock Defeat Mechanism (Man Trap Release)



PreSera Combi is a compact combination of step in chiller and freezer with adjustable racks, only for holding frozen and chilled items.

Temperature range for Chiller is 4° C to 8° C and Freezer is -15° C to -20° C.

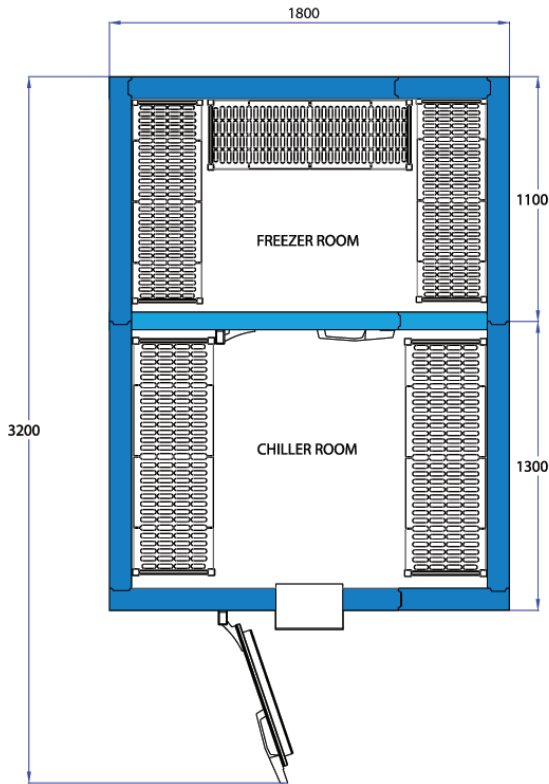

Consumed Power : 3.75 kW | Connected Power : 5.5 kW | Power supply : 415V, 3Ph, 50Hz

